

SITE PLAN OF A PROPOSED G+IV STORIED RESIDENTIAL BUILDING AT PREMISES NO. - 7A, KAMBULIA TOLA LANE, WARD NO. - 10, BR. NO. - II, P.S. - SHYAMPUKUR, KOLKATA - 700 004

LATITUDE: 22°35'54.2"N LONGITUDE: 88°22'01.3"N  
 LATITUDE & LONGITUDE MEASURED NEAR THE CENTRE OF THE PLOT OF LAND

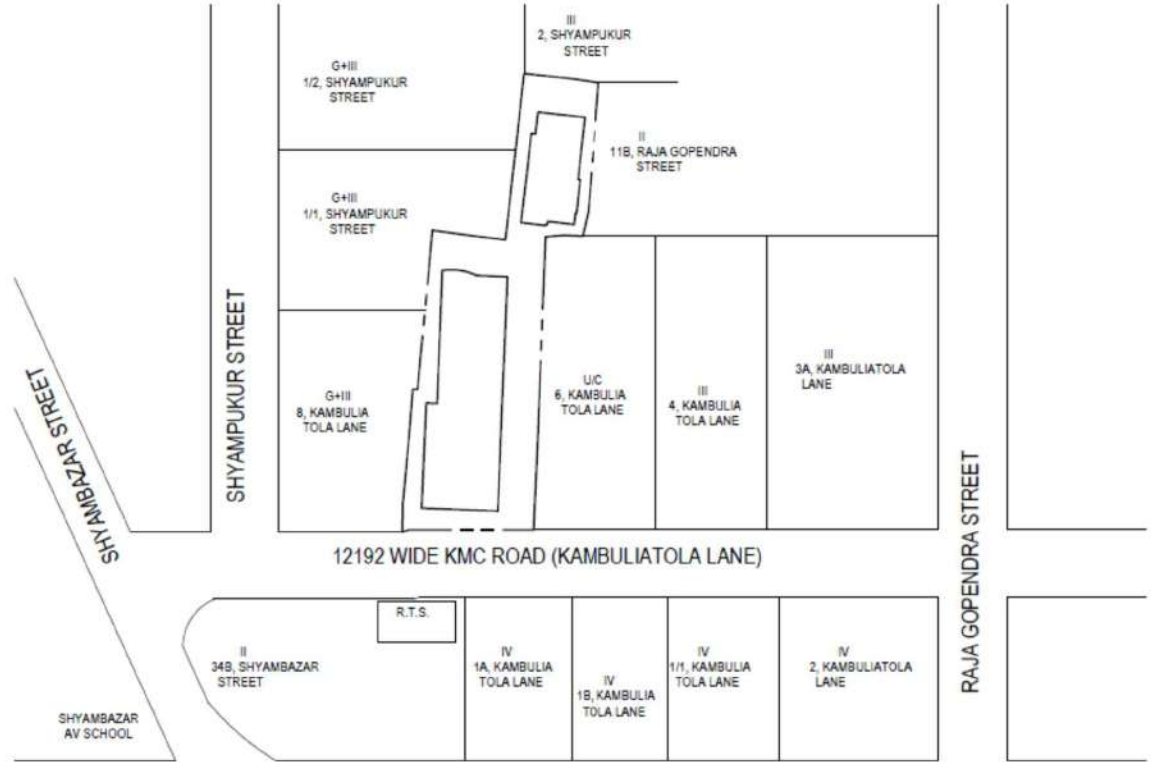
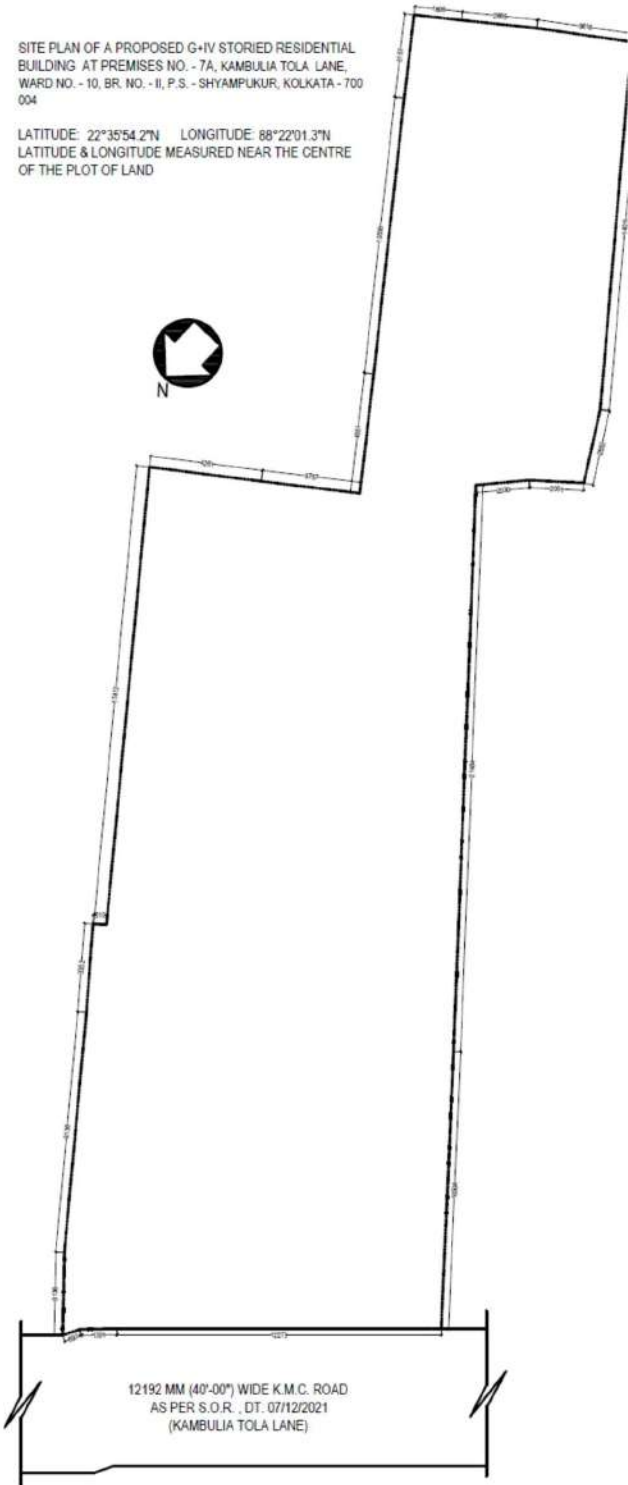

For STRUCTURE INDIA  
*D. Shalaby*  
 PARTNERS